

# 431 FILL CONNECTOR

## STRAIGHT SIMPLE

Fill connector for valves with RPV / non RPV

The fill connector is manufactured in Denmark on state of the art manufacturing equipment, and the quality is monitored throughout the entire process. We supply to all major gas companies world wide and our raw materials are sourced from reliable European suppliers. Individual requirements constantly present new challenges producing unique solutions. Therefore we have many years of experience in making customized solutions.

- Body material only from reliable European suppliers with certificate DS/EN 10204
- Simple use
- Replaceable spare parts
- Swivel design
- All relevant data engraved



**Hydraulic Test Pressure (TP):** 675 bar (Optional)

**Pin:** Monel. Fitted with a fixed or spring loaded pressure pin for the RPV

**Swivel design:** Knurled or simple

**Surface treatment:** Plain or chrome plated

**O2 Cleaning:** According to EIGA Guideline IGC Doc 33/06/E

**O2 Test:** Available with BAM or CTE test (test costs may apply)

**Engraving:** All relevant data are engraved

**Body Material:** Brass

**Inlet connection:** Hose connection according to customer requirement.

*Only use and replace parts with original MGE spareparts.*

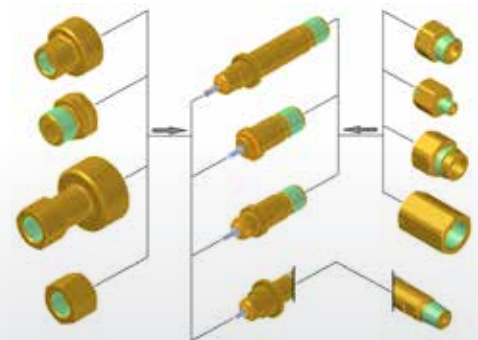

**Müller**  
GAS EQUIPMENT A/S  
GAS CONTROL SOLUTIONS

**80 years of proven experience**

Discover more of our products at: [www.bmv.dk](http://www.bmv.dk)

# 431

## STRAIGHT SIMPLE

Fill Connectors for valves with RPV / non RPV

### Valve connection

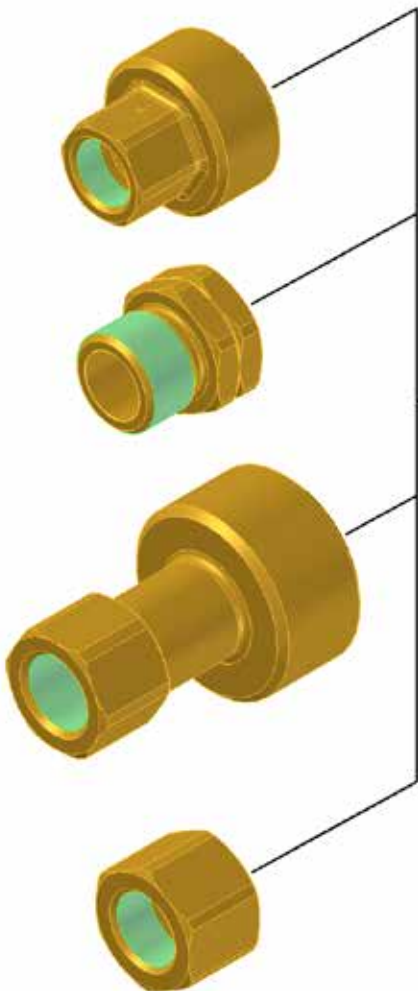

DS2404, DIN, NEN, AFNOR, UNI, NBN, CGA, BS, AS, ISO 5745 or other on request

### Body fixed-/ spring loaded pin

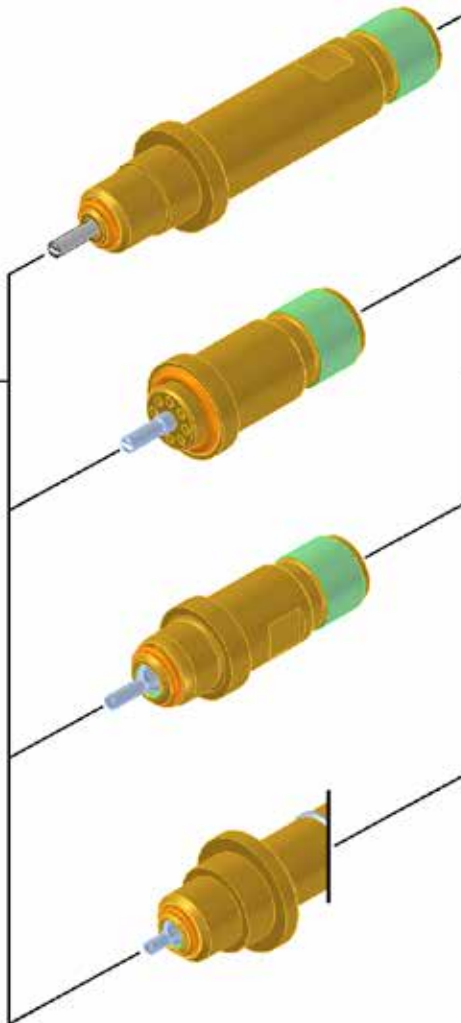

### Hose connection

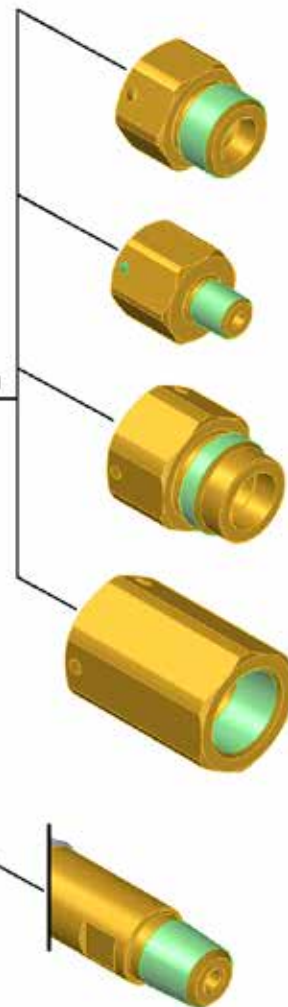

ISO 5145, DIN 477-1, DS 2404, CGA V-1, BS 341-3, AS 2473.2, NF E 29-650, ISO 8434-1, ISO 3253 or other on request

**Only use original spare parts from MGE. Please contact MGE for a complete spare parts list and do not hesitate to contact us for further information.**

# Müller

GAS EQUIPMENT A/S

GAS CONTROL SOLUTIONS

Müller Gas Equipment A/S

Mommarkvej 7-11 · Vollerup · DK-6400 Sønderborg

Telefon: +45 73 42 12 12 · Fax: +45 73 42 12 07 · email: info@bmv.dk · [www.bmv.dk](http://www.bmv.dk)



EC Type-Examinations and QS Certification by:



BAM-TPED-QS-2009/001