

# 070 / 071

Single stage regulator with hose connection - fixed and adjustable

## TECHNICAL SPECIFICATIONS:

- Single stage regulator
- Inlet pressure 1,8-16 bar
- Outlet pressure 0,8-4 bar
- Capacity 24 kg/h *(dependent on inlet and outlet pressure)*
- PN 16

*For further technical specifications on this regulator please see reverse.*



**80** years of proven experience

Discover more of our products at: [www.bmv.dk](http://www.bmv.dk)

## TECHNICAL SPECIFICATIONS:

### 070/071 Single stage regulator with hose connection

- fixed and adjustable

#### About this regulator

The pressure regulators type 070 and 071 are single stage regulators with a wide range of application possibilities. The regulator can be integrated in all systems, which requires a regulated pressure.

#### Mode of operation

The pressure regulators type 070 and 071 are single stage regulators for gas systems which reduce the non-regulated pressure from up to 16 bar to a nominal or adjusted pressure of up to 4 bar.

**DVGW Approved:** according to EN 16129 / CE marking according to 2009/142/EC

**Inlet pressure:** 1,8-16 bar

**Inlet connection:** Pol, hose connection or other on request.

**Outlet connection:** Hose connection or other on request

**Capacity:** 24 kg/h (Propane)

**Outlet pressure:** 0,8-4 bar

**Regulator weight:** Approx. 1 kg

**Gas:** LPG / LNG / Propane / Butane / Natural gas or other on request

**Working temperatur:** -40°C to +50°C

Contact our Sales Department to place your order:

**Phone:** +45 73 42 12 12 · **info@bmv.dk**

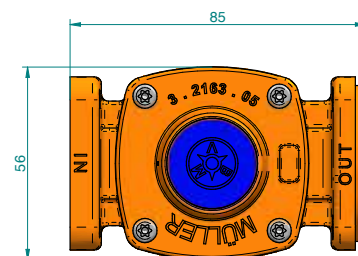
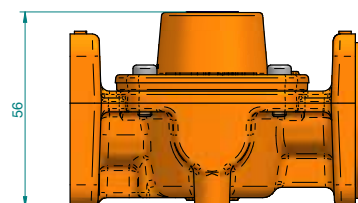
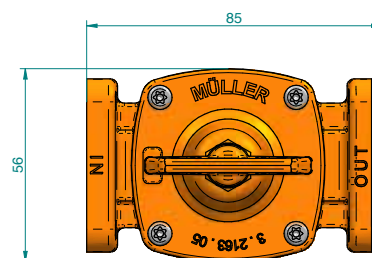
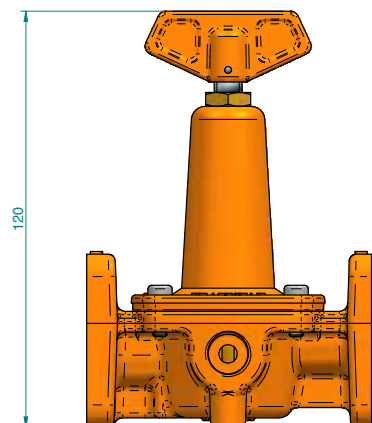

# Müller

GAS EQUIPMENT A/S

GAS CONTROL SOLUTIONS

#### Müller Gas Equipment A/S

Mommarkvej 7-11 · Vollerup · DK-6400 Sønderborg

Telefon: +45 73 42 12 12 · Fax: +45 73 42 12 07 · email: [info@bmv.dk](mailto:info@bmv.dk) · [www.bmv.dk](http://www.bmv.dk)

See our online  
catalogue

